



## Specification **FM200(2V200Ah)**

<b>Cells Per Unit</b>	1
<b>Voltage Per Unit</b>	2
<b>Nominal Capacity</b>	200Ah@10hour-rate to 1.80V per cell @25°C
<b>Weight</b>	Approx. 13 Kg (Tolerance ±3%)
<b>Internal Resistance</b>	Approx. 0.80 mΩ
<b>Terminal</b>	F10(M8)
<b>Max. Discharge Current</b>	1000A (5 sec)
<b>Short Circuit Current</b>	2650A
<b>Design Life</b>	20 years (Float charging)
<b>Recommended Maximum Charging Current</b>	40 A
<b>Reference Capacity</b>	C1 119.0AH C3 155.1AH C5 175.0AH C10 200.0AH
<b>Standby Use Voltage</b>	2.27 V~2.30 V @ 25°C Temperature Compensation: -3mV/°C/Cell
<b>Cycle Use Voltage</b>	2.43 V~2.47 V @ 25°C Temperature Compensation: -4mV/°C/Cell
<b>Operating Temperature Range</b>	Discharge: -20°C~60°C Charge: -0°C~50°C Storage: -20°C~60°C
<b>Normal Operating Temperature Range</b>	25°C ±5°C
<b>Self Discharge</b>	Westar Valve Regulated Lead Acid (VRLA) batteries can be stored for up to 6 months at 25°C and then recharging can be stored for up to 6 months at 25°C and then recharging than 3% at 25°C. Please charge batteries before using.
<b>Container Material</b>	A.B.S. UL94-HB, UL94-V0 Optional.

FM 2V series is a general purpose battery with 20 years design life in float service. It meets with heavy duty grids, thicker plates, special additives and advanced AGM valve regulated technology, the FM 2V series battery provides consistent performance and long service life. The new grid design effectively reduces the internal resistance, which provides higher specific energy density and excellent high rate discharge characteristics. It is suitable for communications back-up power and EPS/UPS applications.



MH60689

ED131130285E

## Dimensions

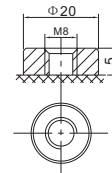
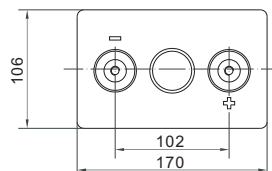
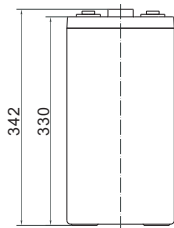

F10 TERMINAL

Length	170±2mm (6.69 inches)
Width	106±2mm (4.17 inches)
Height	330±2mm (13.0 inches)
Total Height	342±2mm (13.5 inches)
Terminal	Value
M5	6~7 N*m
M6	8~10 N*m
M8	10~12 N*m

Unit: mm

### Constant Current Discharge Characteristics : A (25°C)

F.V/Time	15MIN	30MIN	1HR	2HR	3HR	4HR	5HR	8HR	10HR
1.60V	266.8	197.4	119.0	71.7	54.7	43.6	36.7	25.3	21.3
1.67V	259.8	193.0	116.8	70.7	53.9	43.1	36.3	25.1	21.1
1.70V	250.7	187.3	113.8	69.3	53.0	42.3	35.7	24.7	20.8
1.75V	238.7	179.8	110.0	67.4	51.7	41.4	35.0	24.3	20.5
1.80V	223.3	170.1	105.0	65.0	50.0	40.1	34.0	23.7	20.0
1.85V	203.9	157.7	98.5	61.9	47.8	38.5	32.7	22.9	19.4

### Constant Power Discharge Characteristics : WPC (25°C)

F.V/Time	15MIN	30MIN	1HR	2HR	3HR	4HR	5HR	8HR	10HR
1.60V	484.7	369.0	225.5	137.0	105.0	84.1	71.7	49.8	42.0
1.67V	479.0	364.7	222.9	135.8	104.1	83.4	71.1	49.4	41.6
1.70V	464.7	355.2	218.0	133.5	102.5	82.2	70.1	48.8	41.1
1.75V	447.0	342.6	211.6	130.5	100.4	80.6	68.8	47.9	40.5
1.80V	422.4	325.7	203.0	126.3	97.4	78.5	67.0	46.8	39.6
1.85V	389.5	304.1	191.6	120.7	93.5	75.5	64.6	45.3	38.4

(Note) The above characteristics data are average values obtained within three charge/discharge cycle not the minimum values.

# FM200 (2V200Ah)

## Discharge Characteristics Curve

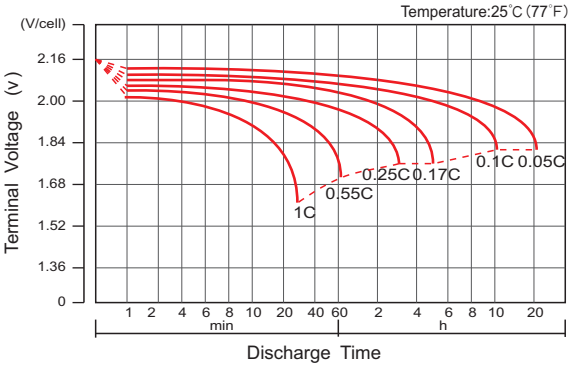

## Charge Characteristic Curve For Standby Use

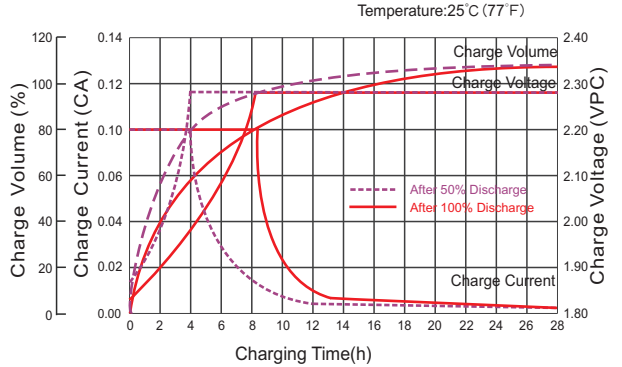

## Cycle Life In Relation To Depth Of Discharge

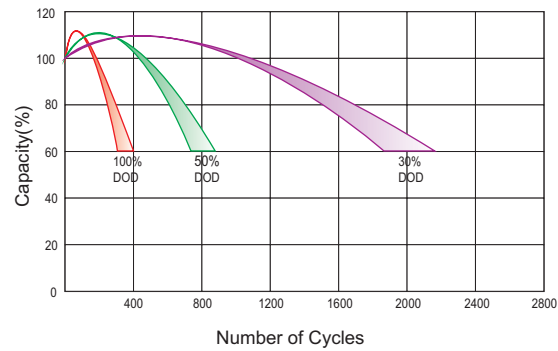

## Relationship Between Charging Voltage And Temperature

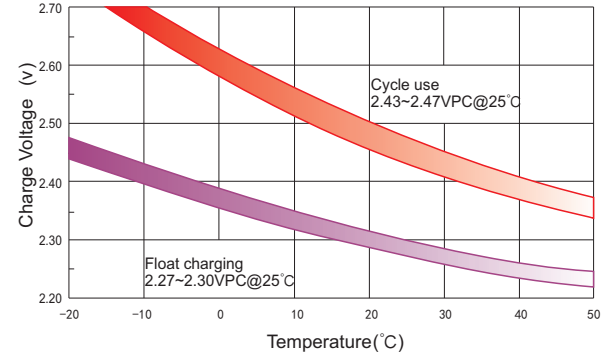

## Temperature Effects On Capacity

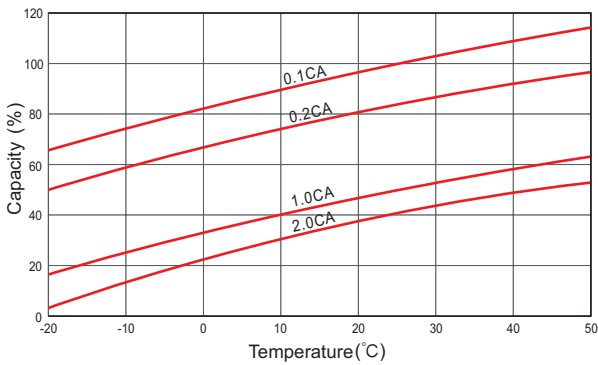

## Storage Characteristics

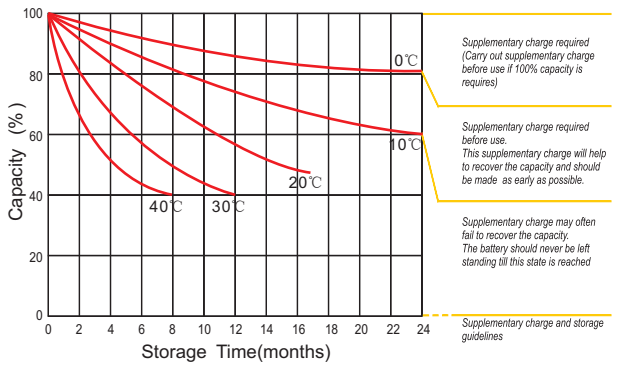

## Effect Of Temperature On Long Term Life

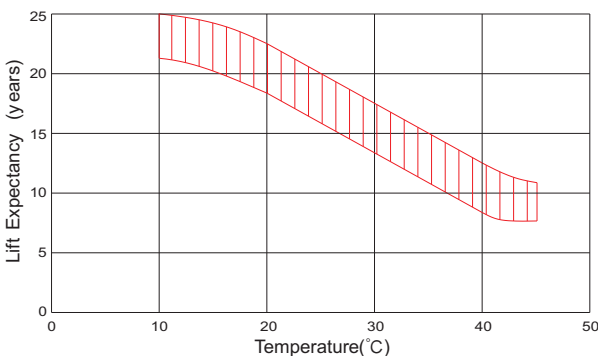

## Charge Characteristic Curve For Standby Use

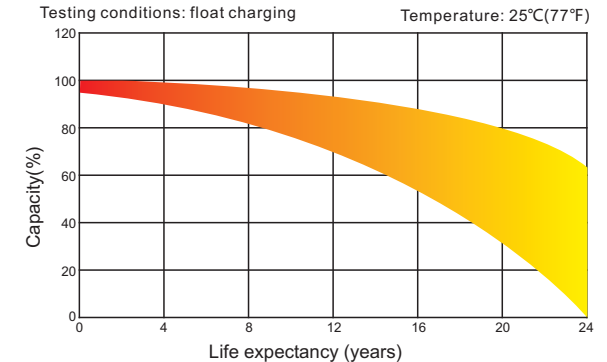

(Note) All above information shall be changed without prior notice, Westar reserves the right to explain and update the latest information.